

PROCEEDINGS OF THE COLLECTOR, RANGA REDDY DISTRICT
PRESENT::SRI.M.RAGHUNANDAN RAO, I.A.S.,
Procs. No.LC3/3110/2013
Dated: 18.02.2016

Sub: Transfer of Government Lands - Ranga Reddy District - Malkajgiri Division - Medchal Mandal - Girmapur Village - Sy.No.345 extent of Ac.5-00 - Allotment of Govt. land for construction of Government Polytechnic College - Handing over advance possession - Orders issued - Reg.

- Read: 1. Commissioner of Department of Technical Educational, Hyd.Lr.No.K3/New.Poly/2012, dt: 13.06.2013.
2. This office Lr.No.LC3/3110/2013, dt: 28.06.2013.
3. Tahsildar, Medchal Mandal, Lr.No.B/674/2013, dt:21.06.2014.
4. Commissioner of Department of Technical Educational DO.Lr.No.K3/New Poly/2014, dt:15-07-2014
5. OSD/Principal, Government Polytechnic, R.R.Dist.Lr.No.GPT/MDCL, Dt: 15-07-2014.
6. Director, Employment & Training, Lr.No.B1/880/2014 Dt:26.06.2015.
7. The Commissioner, D.O.Lr.No.K3/New Poly/2014, dated:2-8-2015.
8. SGDC & RDO Lr.No.B/1798/2015, Dt: 09.10.2015
9. The Assistant Director, (FAC) Survey & land record Lr.No.Rc.A5/3618/2015, dt: 31.10.2015.
10. Tahsildar Medchal (M), Lr.No.B/1274/2015,dt:7.11. 2015.
11. The Principal Government Polytechnic, Medchal Lr.No. B/mdcl/11/2015, dated:18-12-2015.
12. The Tahsildar Medchal Mandal Lr.No.B/985/2015, dated:25-01-2016.
13. The AD S&LR, R.R.Dist Rc.No.A5/405/2016, dated: 12-02-2016.
14. The Tahsildar Medchal Mandal Lr.No.B/985/2015, dated:13-02-2016.

-oOo-

ORDER:

The Commissioner of Technical Education has requested for allotment of Government land an extent of Ac 5-00 in Medchal Village & Mandal for construction of Government Polytechnic College at Medchal.

In the reference 6th cited, the Director, Employment & Training has not agreed to take up construction of Government Polytechnic Village in the premises of Government, ITI Medchal as the land has been purchased by the Department and the same is Dept own land.

The Commissioner of Technical Education vide reference 7th cited, further requested to identify any other land in or around Medchal for construction of Government Polytechnic College at Medchal and requested to issue orders for hand over advance possession of the land pending alienation of land in favour of OSD concerned Government Polytechnic.

On being called, the SQDC & RDO Malkajgiri Division has reported that, the land has been identified by the Tahsildar Medchal Mandal in Sy.No.345 Adm 46-00 gts of Girmapur Village, Medchal Mandal for construction of Polytechnic College. However, the said land was already proposed for alienation to NTPC Employees Co.op house building Society Limited for the purpose of construction of houses. Further reported that, the land in Sy.No.345 of Girmapur Village got surveyed and it was found that out of Ac 53-00 only an extent of Ac 36-00 is free from any encumbrances/encroachment.

In the reference 10th cited, the Tahsildar Medchal Mandal has reported that, as per Pahani for the year 2014-15, the land in S.No.345 Extent of Ac 243-25 gts of Girmapur Village is classified as Sarkari and requested to pass appropriate orders on alienation of land to an extent of Ac 5-00 in Syt.No.345 of Girmapur Village in favour of Government Polytechnic College Medchal.

Vide reference 11th cited, the Principal Government Polytechnic College has submitted requisition proposals in Annexure-XI along with Appendix XXIX and conditions for grant of state lands with a requested to handover advance possession of land, pending alienation of Government land to an extent of Ac 5-00 is available in Sy.No.345 situated at Girmapur Village, Medchal Mandal for construction of Government Polytechnic College, at Medchal.

Further, the Principal Government Polytechnic College has requested to identify the another 5-00 acres of land in the same Survey number as the proposed land not feasible for construction of College.

Accordingly, the Tahsildar Medchal Mandal has reported that, the Mandal Surveyor has identified an alternative land for an extent of Ac 5-00 in Sy.No.345 of Girmapur Village, for construction of Government Polytechnic College, at Medchal.

In the reference 13th cited, the Assistant Director, Survey and Land Records, R.R.Dist has submitted Sub-Divisions Records (SDR) in respect of the land in Sy.No.345/2 to an extent of Ac 5-00 situated at Girmapur Village, Medchal Mandal for construction of Government Polytechnic College at Medchal. The details of Sub-Division and Phodi Sketch are as follows:

STATEMENT SHOWING THE SUB-DIVISION OF THE GIRMAPUR VILLAGE, MEDCHAL MANDAL OF RANGA REDDY DISTRICT.

Area and the classification of assignment													Particulars of the proposed Sub-Division		
No. of present field of Division	Dry / Wet or Patta	Total Survey Area	Assessment	Name of the present Regd. Holders	Dry/Wet/Poramboke	Sub-Division No. of letter	Govt. land sub-division	Balance Area	Assessment	No. of proposed register holder	Signature of party	Area were well defined boundaries on the ground & whether sub-divisions have been duly demarcation	Reasons for commissions if any on the part of particulars of SIGNVCD (2)	Reason for Sub-Division	Remarks
1	2	3	4	5	6	7	8	9	10	11	12	13	14	15	16
345	Dry	399-10	-	-	Dry	1	-	394-10	-	-	-	-	-	-	Govt. Land
						2	5-00	-	-	-	-	-	-	-	For construction of Govt. Polytechnic College at Medcha

PHODI - SKETCH

AD FILE NO. 15/1455/2016
DT. 12-2-2016

File No. B/185/2016

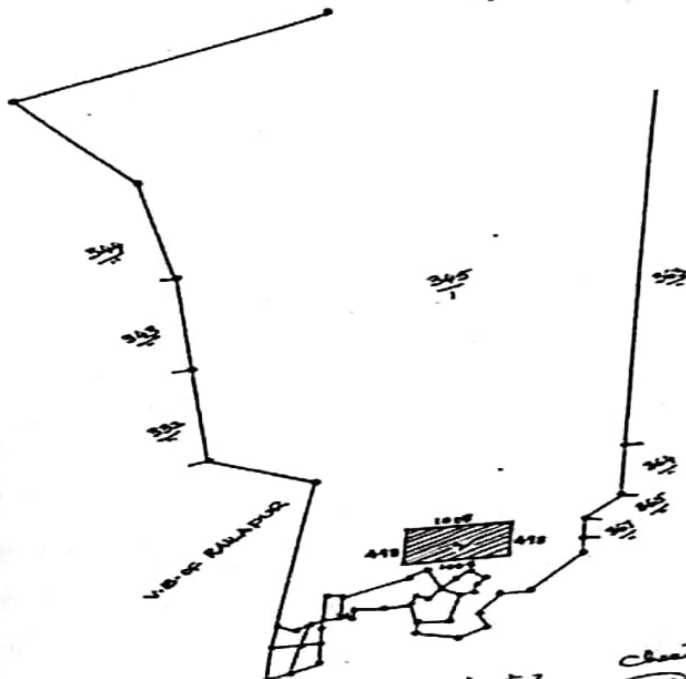

Scale 1:1000
Village - Girmapur
Mandala - Medchal
District - Rangareddy

(B. Sujinivada Rao)
Mandal - Surveyor

Regd. Surveyor, D. J. Rao
12-2-2016

Checked
[Signature]

Assistant Director
Survey & Land Records
Rangareddy District

The Government vide Memo .No. 20264/Assn.I(1)/2013, dt: 06.11.2013 accorded permission to the District Collectors that advance possession of Govt. shall be given in case of Government land i.e., one Govt. Department to another Govt. Department (under BSO-23) and shall ensure & furnish regular alienation / transfer of land proposals in full-shape after following the due procedure to the Land Management Authority.

Therefore, in view of the above, after careful examination of the matter, the Tahsildar, Medchal Mandal is hereby accorded permission and directed to hand over advance possession of the land as per the Sub-division sketch approved by the AD (S&LR), R.R.Dist to an extent of Ac.5-00 (Five Acres only) of Government Land in Sy.No.345/2 situated at Girmapur Village, Medchal Mandal to the Officer on Special Duty (OSD) Government Polytechnic as per permission accorded by the Govt. Memo No. 20264/Assn.I(1)/2013, dt: 06.11.2013 under proper cover of Panchanama for the purpose of construction of Government Polytechnic College, at Medchal with loan assistance from the NABARD funds under RIDF - XX Scheme. Necessary budget is available in B.E. 2015-2016, subject to pending finalization of regular alienation proposals and requested to send compliance report along with regular alienation / transfer of land proposals in accordance with "New Land Allotment Policy" as per G.O.Ms.No.571, Rev. (Assn.I) Dept., dt:14.09.2012 within a week positively.

Sd/-
District Collector,
Ranga Reddy District.

// Attested //

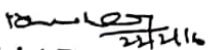
District Revenue Officer,
Ranga Reddy District.

To
The Tahsildar,
Medchal Mandal,
Ranga Reddy District, with a request to send compliance report along with attested copy of Panchanama.

Copy to the Officer on Special (OSD) with a request to take over the advance possession as per GO Ms No. 571, dt: 14.09.2012, at the earliest.

Copy submitted to the Commissioner, Department of Technical Education, BRKR Bhavan, Government Offices Complex Vth Floor, Hyderabad.

Copy to the Principal, Government Polytechnic, Medchal, R.R.Dist.

Copy to the SGDC & RDO Malkajgiri Division for necessary action.